

**LATITUDE AND LONGITUDE OF PREMISES NO. 2A,
MIRZA GHALIB STREET, WARD NO. - 046,
BOROUGH - VI, WITHIN K.M.C. KOLKATA-700087,
P.S.- NEW MARKET, ASSESSEE NO. - 110464700018**

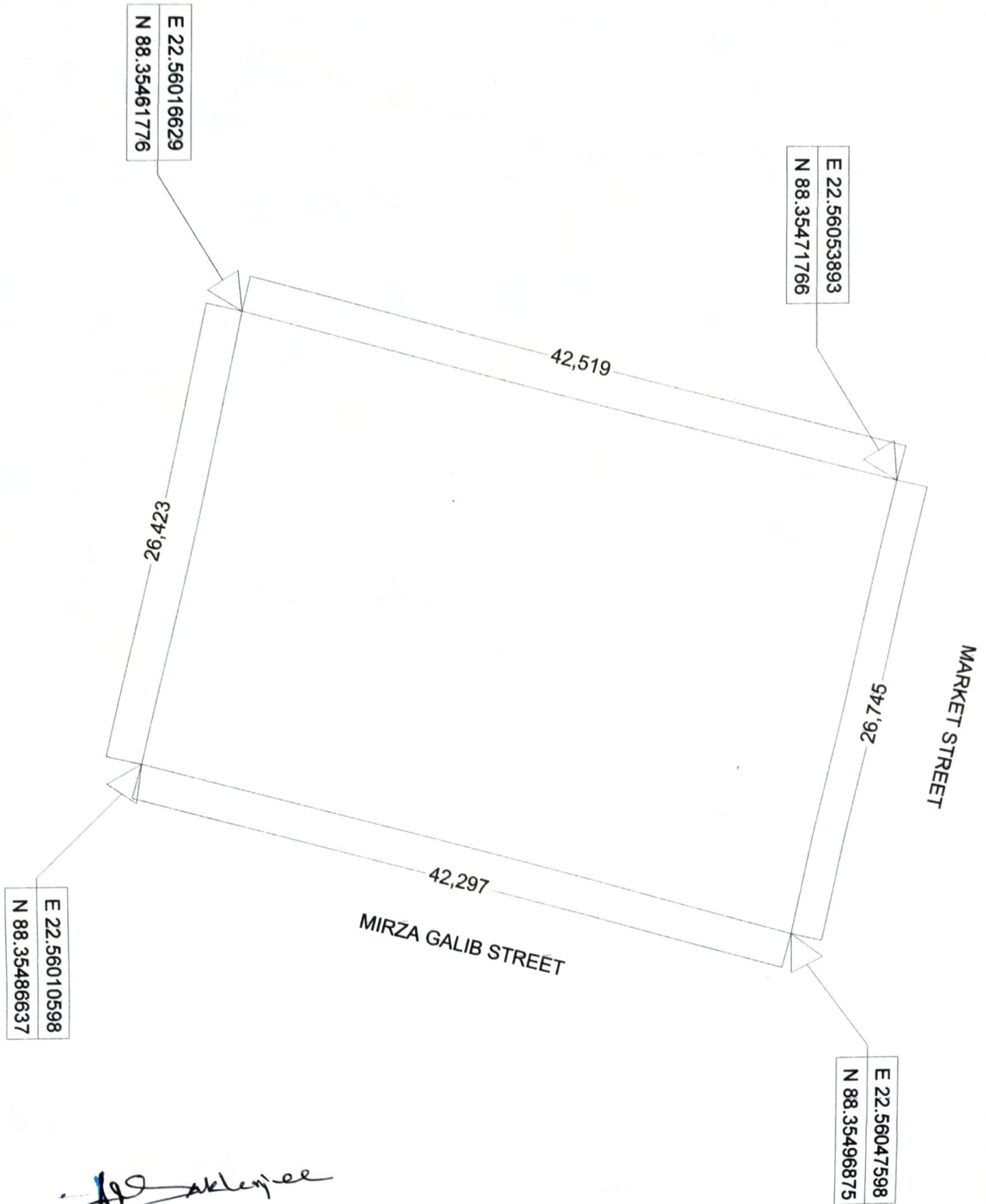

amlan mukherjee
AMLAN MUKHERJEE
Regd. Architect
CA/98/23583

SIGNATURE OF ARCHITECT.